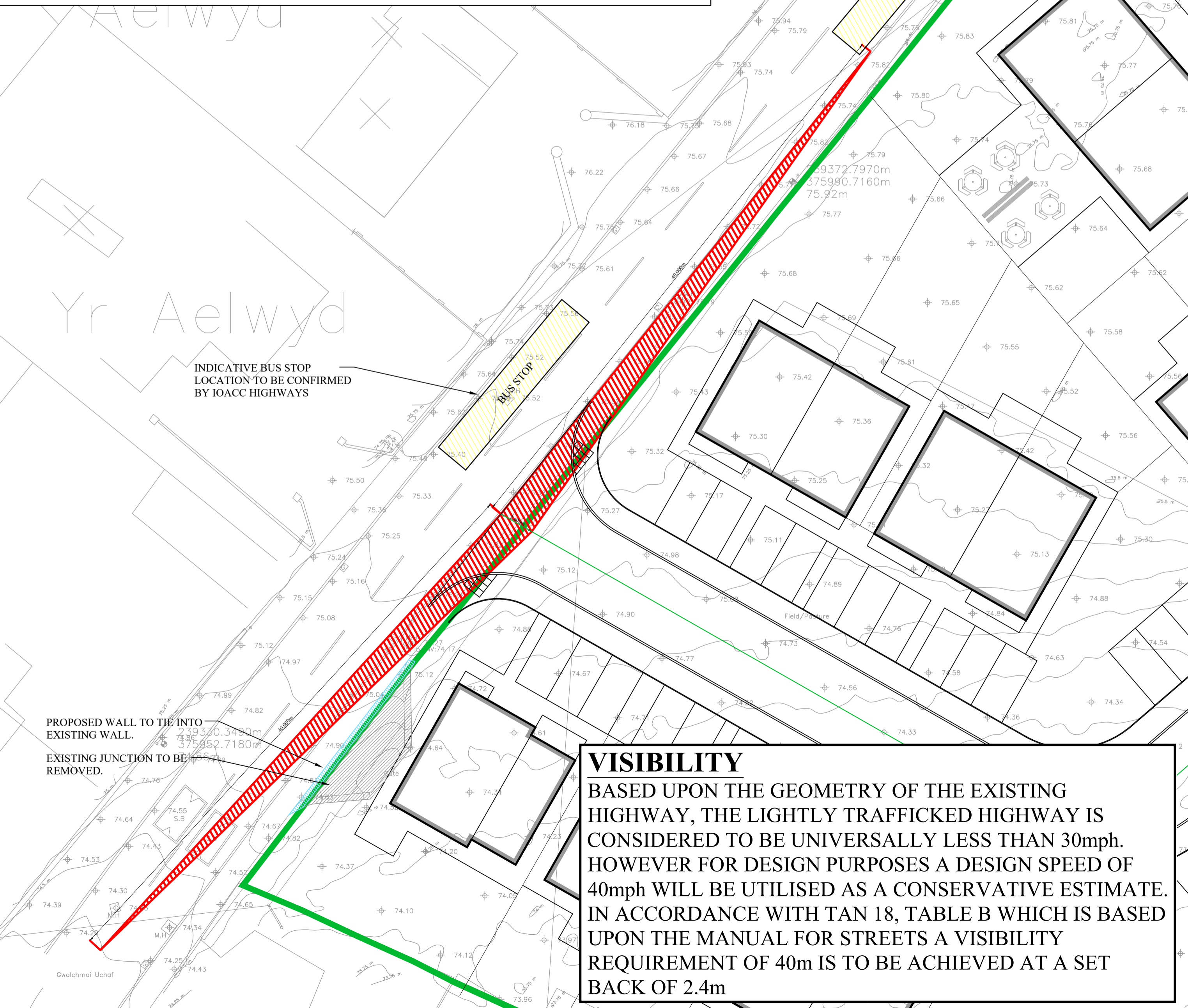

FIGURE 1. FROM ENTRANCE LOOKING SOUTH-WEST



FIGURE 2. FROM ENTRANCE LOOKING NORTH-EAST



VISIBILITY
 BASED UPON THE GEOMETRY OF THE EXISTING HIGHWAY, THE LIGHTLY TRAFFICKED HIGHWAY IS CONSIDERED TO BE UNIVERSALLY LESS THAN 30mph. HOWEVER FOR DESIGN PURPOSES A DESIGN SPEED OF 40mph WILL BE UTILISED AS A CONSERVATIVE ESTIMATE. IN ACCORDANCE WITH TAN 18, TABLE B WHICH IS BASED UPON THE MANUAL FOR STREETS A VISIBILITY REQUIREMENT OF 40m IS TO BE ACHIEVED AT A SET BACK OF 2.4m

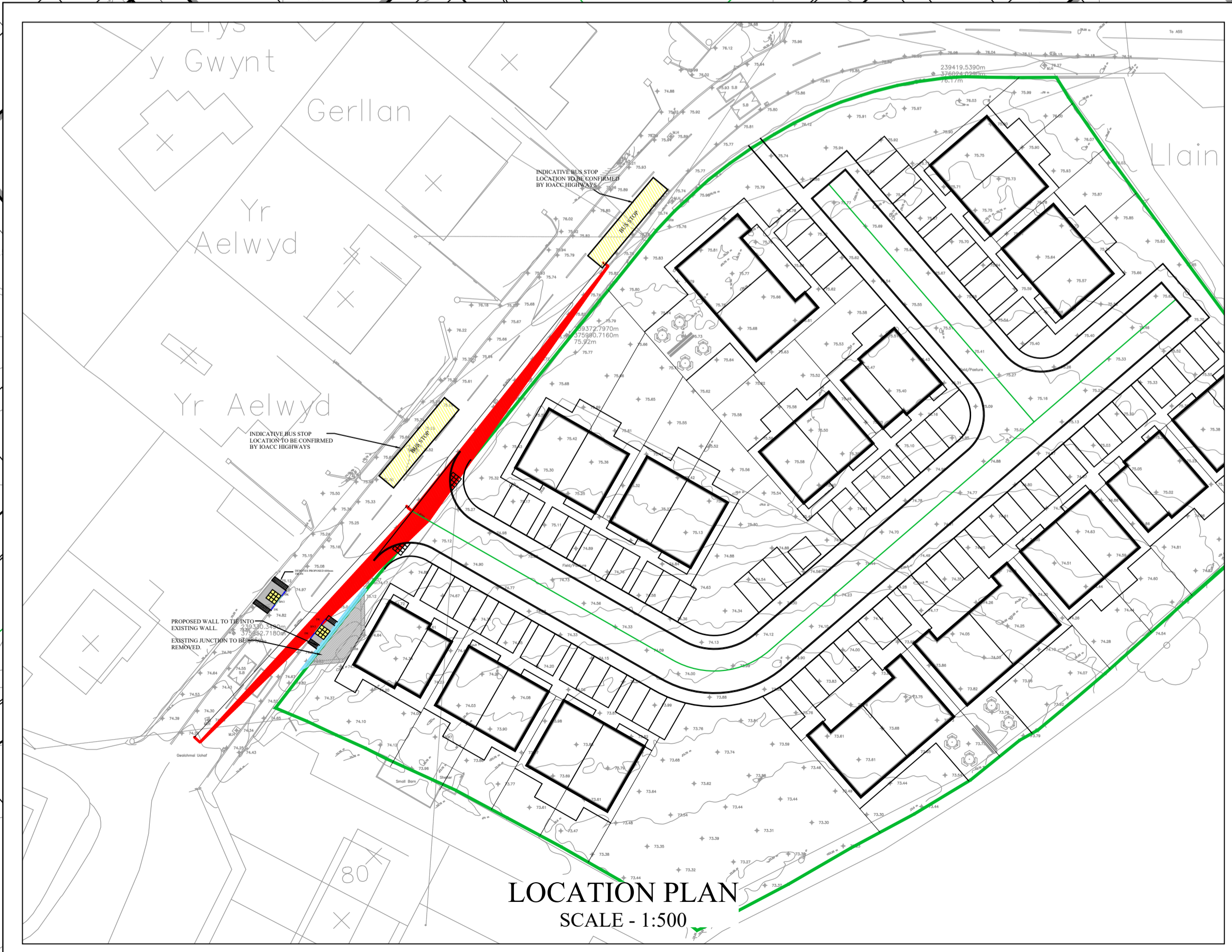

- NOTES**
- DO NOT SCALE FROM THIS DRAWING.
 - ALL LEVELS IN METRES UNLESS NOTED OTHERWISE ON DRAWING.
 - ALL DIMENSIONS AND LEVELS TO BE CHECKED ON SITE PRIOR TO UNDERTAKING ANY WORKS. ORDERING MATERIALS OR FABRICATING ANY COMPONENTS.
 - THIS DRAWING IS TO BE READ IN CONJUNCTION WITH ALL OTHER RELEVANT ENGINEERS' AND ARCHITECT'S DRAWINGS AND RELEVANT SPECIFICATION CLAUSES.
- KEY**

SI	PO	13.06.22	FIRST ISSUE				
SUITABILITY	REV	DATE	DESCRIPTION		Org	CHK'd	Appl. Auth.

PROJECT TITLE:
SITE ADJ TO LLAIN RALLT, GWALCHMAI

DRAWING TITLE:
PROPOSED VISIBILITY DISPLAY AND HIGHWAY IMPROVEMENT

DRAWING No:	PROJECT:	ORIGINATOR:	VOL.:	LOC.:	TYPE:	ROLE:
09422	CCE	V1	XX	40:40:01	C	
	50:30	0008	S1	P01		

ORIGINATOR:	DATE:	SCALE:	ORIGINAL SIZE:
M.Jones	13.06.2022	1:200	A1



Address: CADARN Consulting Engineers Ltd,
 Suite B,
 Anglesey Business Centre,
 Bryn Cefni,
 Llangeifni,
 LL77 7XA
 E-mail: Admin@cadarnconsulting.co.uk
 Tel: 01407 730912